

This document (both in its graphic part and the data referring to surfaces) is merely indicative, without prejudice to the most accurate information contained in the technical documentation of the home. The situation of the house and the exteriors may vary depending on the plot acquired. All the furniture shown in this plan, with the exception of the kitchen, toilets, bathrooms and cabinets, has been included for merely indicative and decorative purposes.

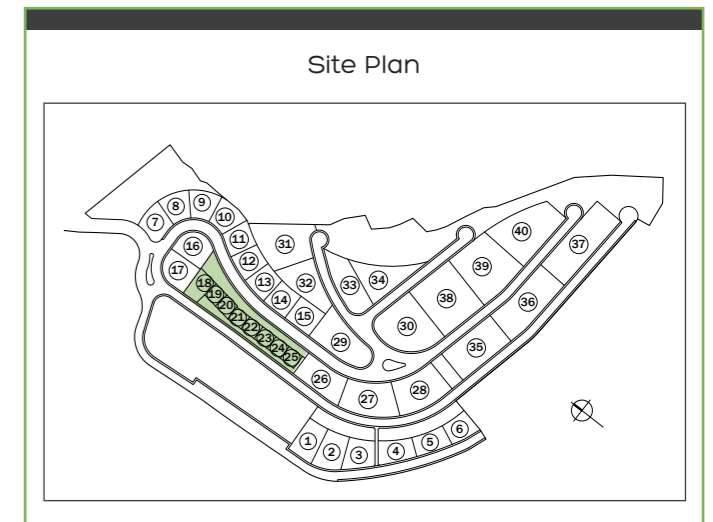





HOUSE		POLOP
Situation		Plots 18-25
GROUND FLOOR		
INTERIOR FLOOR AREA		
1.1	Hall	6.74m <sup>2</sup>
1.2	Living-Dining-Kitchen	47.59m <sup>2</sup>
1.3	Toilet	4.26m <sup>2</sup>
1.4	Facilities / Laundry	4.71m <sup>2</sup>
Total		63.30m <sup>2</sup>
EXTERIOR FLOOR AREA		
E1	Covered Porch	17.16m <sup>2</sup>
1.3 E2	Porch	39.70m <sup>2</sup>
E3	Parking	27.41m <sup>2</sup>
E4	Pool	12.00m <sup>2</sup>
Total		96.27m <sup>2</sup>
HOUSE		
TOTAL FLOOR AREA		
Interior floor area		138.78m <sup>2</sup>
Exterior floor area		108.73m <sup>2</sup>
TOTAL		247.51m <sup>2</sup>
TOTAL BUILT AREA		
Ground floor		82.56m <sup>2</sup>
First floor		90.69m <sup>2</sup>
TOTAL		173.25m <sup>2</sup>

The indicated areas are calculated according to the Decreto 218/2005 of information to the consumer in the sale and lease of houses.

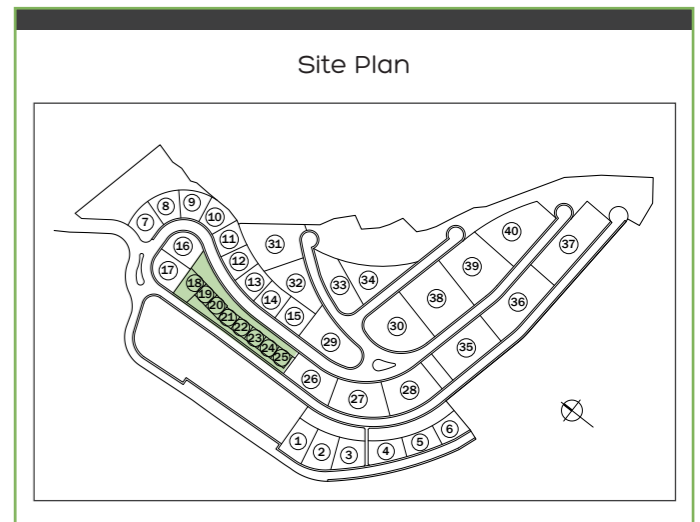
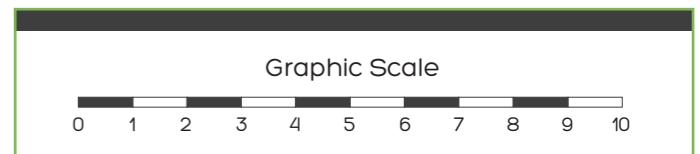

This document (both in its graphic part and the data referring to surfaces) is merely indicative, without prejudice to the most accurate information contained in the technical documentation of the home. The situation of the house and the exteriors may vary depending on the plot acquired. All the furniture shown in this plan, with the exception of the kitchen, toilets, bathrooms and cabinets, has been included for merely indicative and decorative purposes.



HOUSE		POLOP
Situation		Plots 18-25
<b>FIRST FLOOR - OPTION A</b>		
INTERIOR FLOOR AREA		
2.1	Stair	5.97m <sup>2</sup>
2.2	Corridor	5.25m <sup>2</sup>
2.3	Bedroom 1	18.96m <sup>2</sup>
2.4	Bath 1	5.18m <sup>2</sup>
2.5	Bedroom 2	14.01m <sup>2</sup>
2.6	Bedroom 3	18.26m <sup>2</sup>
2.7	Bath 2	7.85m <sup>2</sup>
Total		75.48m <sup>2</sup>
EXTERIOR FLOOR AREA		
T1	Terrace	12.46m <sup>2</sup>
<b>HOUSE</b>		
TOTAL FLOOR AREA		
Interior floor area		138.78m <sup>2</sup>
Exterior floor area		108.73m <sup>2</sup>
<b>TOTAL</b>		<b>247.51m<sup>2</sup></b>
<b>TOTAL BUILT AREA</b>		
Ground floor		82.56m <sup>2</sup>
First floor		90.69m <sup>2</sup>
<b>TOTAL</b>		<b>173.25m<sup>2</sup></b>

The indicated areas are calculated according to the Decreto 218/2005 of information to the consumer in the sale and lease of houses.

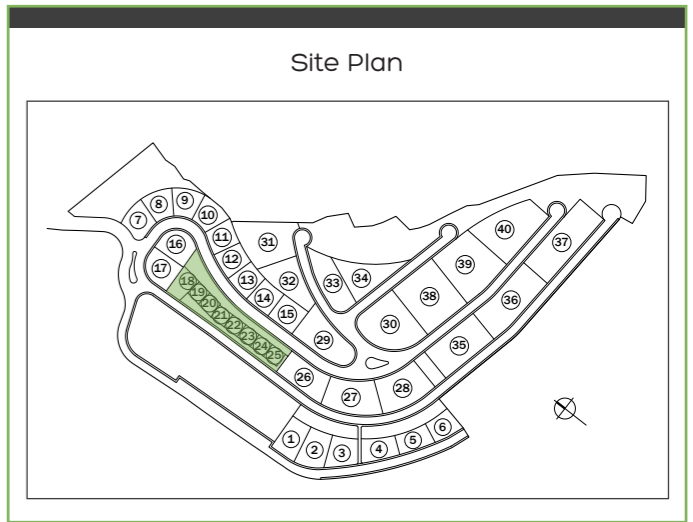
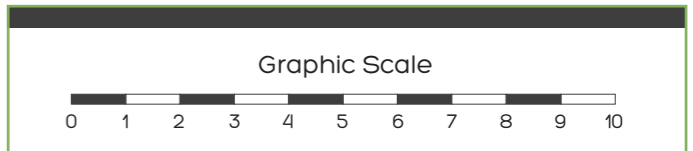

This document (both in its graphic part and the data referring to surfaces) is merely indicative, without prejudice to the most accurate information contained in the technical documentation of the home. The situation of the house and the exteriors may vary depending on the plot acquired. All the furniture shown in this plan, with the exception of the kitchen, toilets, bathrooms and cabinets, has been included for merely indicative and decorative purposes.



This document (both in its graphic part and the data referring to surfaces) is merely indicative, without prejudice to the most accurate information contained in the technical documentation of the home. The situation of the house and the exteriors may vary depending on the plot acquired. All the furniture shown in this plan, with the exception of the kitchen, toilets, bathrooms and cabinets, has been included for merely indicative and decorative purposes.



HOUSE		POLOP
Situation		Plots 18-25
<b>FIRST FLOOR - OPTION B</b>		
INTERIOR FLOOR AREA		
2.1	Stair	5.97m <sup>2</sup>
2.2	Corridor	5.25m <sup>2</sup>
2.3	Bedroom 1	18.96m <sup>2</sup>
2.4	Bath 1	5.18m <sup>2</sup>
2.5	Bedroom 2	12.84m <sup>2</sup>
2.6	Bedroom 3	11.32m <sup>2</sup>
2.7	Bedroom 4	7.71m <sup>2</sup>
2.8	Bath 2	7.85m <sup>2</sup>
Total		75.08m <sup>2</sup>
EXTERIOR FLOOR AREA		
T1	Terrace	12.46m <sup>2</sup>
<b>HOUSE</b>		
TOTAL FLOOR AREA		
Interior floor area		138.38m <sup>2</sup>
Exterior floor area		108.73m <sup>2</sup>
TOTAL		247.11m <sup>2</sup>
TOTAL BUILT AREA		
Ground floor		82.56m <sup>2</sup>
First floor		90.69m <sup>2</sup>
TOTAL		173.25m <sup>2</sup>

The indicated areas are calculated according to the Decreto 218/2005 of information to the consumer in the sale and lease of houses.

